

Integral V

INTEGRATED SERIES

NEW

The Integral V™ system was developed to reduce costs, increase application flexibility and ease of installation.

The rail consists of durable anodized aluminum framing and carbon steel angled raceways. Integral V components consist of various guide rails, snap-in clamps and carriages; each lending itself to high load capacity, rigidity and torque resistance. The Integrated Series eliminates tolerance stack with qualified edges creating precise alignment.

- **End-joinable for longer runs**
- **Two carriage styles** - flat plate with or without t-slots
- **Optional lube pads or wheel covers for maintenance free options**
- **Max speed of 10m/s**

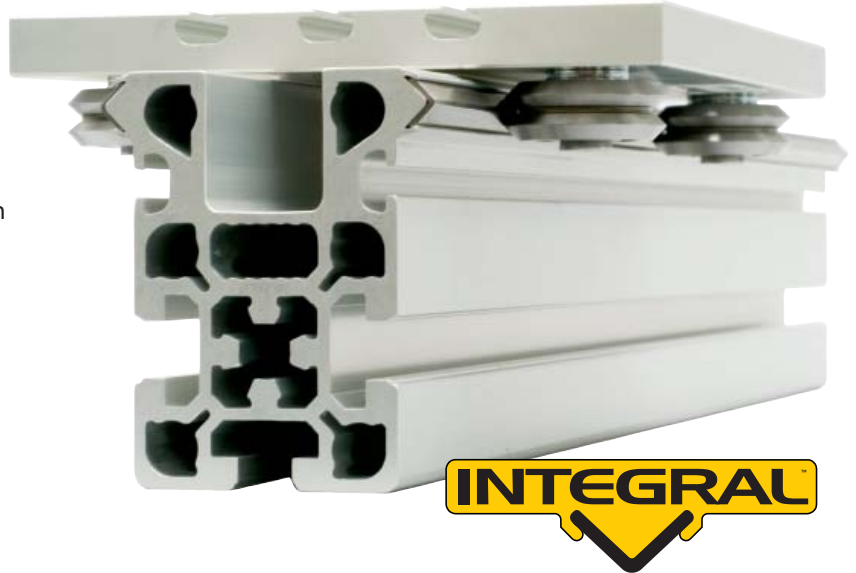

PATENT PENDING

HIGH CONTACT LOAD & WEAR RESISTANT

CARRIAGE STYLES

Custom carriages available upon request.

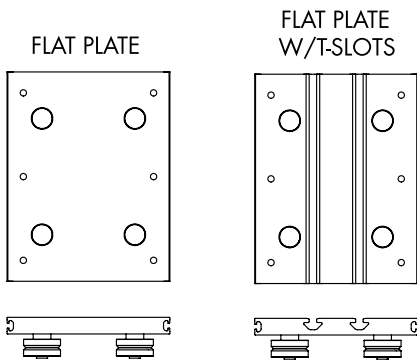

IVTAAG



IVTAAH

Part #	CARRIAGE LOAD RATING									
	Radial		Axial		Moment					
	Fz	Fz	Fy	Fy	Roll Mx		Pitch Mz		Yaw My	
	(N)	(lbf)	(N)	(lbf)	(N-m)	(lbf-ft)	(N-m)	(lbf-ft)	(N-m)	(lbf-ft)
IVTAAG	5,560	1,250	5,560	1,250	173	127	350	258	348	256
IVTAAH	5,560	1,250	5,560	1,250	173	127	350	258	348	256

Load data shown in table is based on 100 kilometer travel.

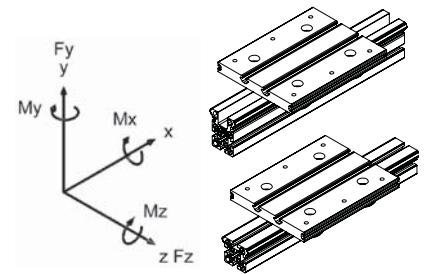

DIMENSIONAL DATA

IVTAAG

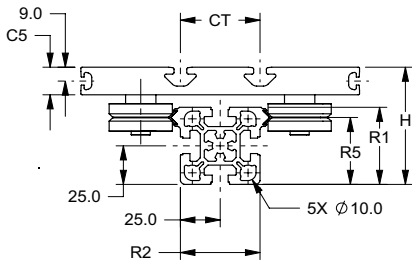

IVTAAH

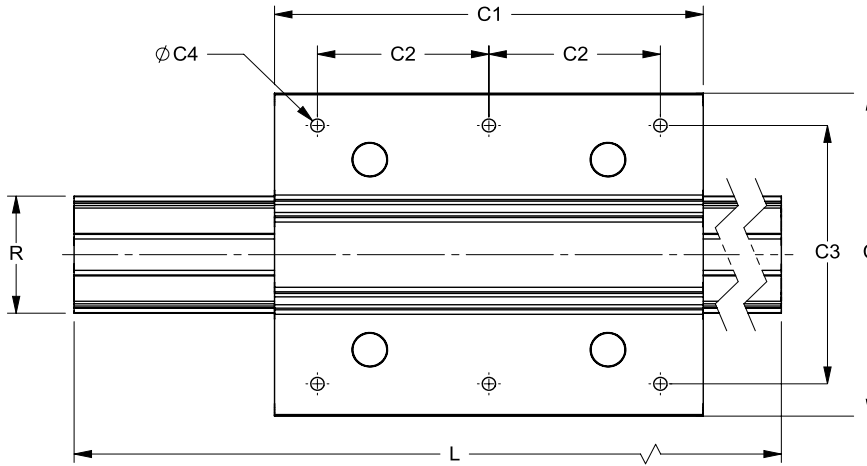
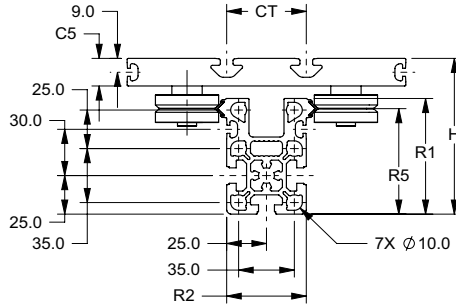

Part #	H	R	R1	R2	R5	C	C1	C2	C3	CT	C4 TAP	C5	L MAX
IVTAAG	76	65	50	50	43.4	175	225	90	140	50	M8 X 1.0	17.9	4000
IVTAAH	101	65	75	50	68.4	175	225	90	140	50	M8 X 1.0	17.9	4000

All dimensions in millimeters.

LUBRICATION OPTIONS

Lube Holder -
Micropoly® insert lubricated raceway

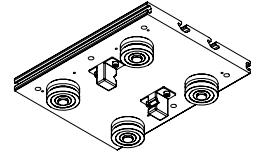

Wheel Cover -
Semi-enclosed cover protects from contaminated debris

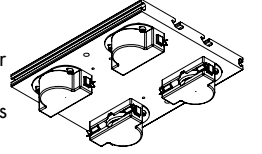

Wheel Cover & Lube Holder -
Semi-enclosed cover protects from contaminated debris, plus Micropoly inserts

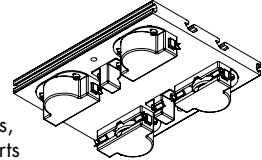

PRELOAD OPTIONS

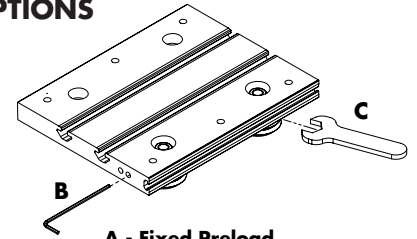

A - Fixed Preload

B - Side Screw Adjustable Preload (Standard)

C - Hex Head Adjustable Preload

ORDERING INFORMATION

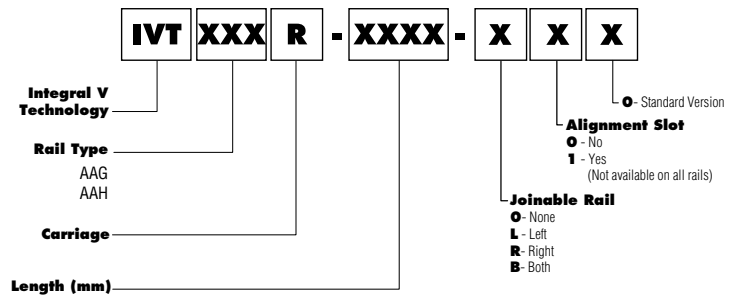
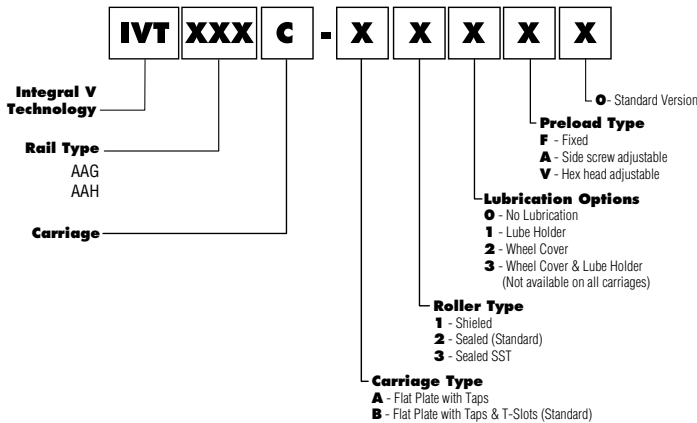

Product information and 2D/3D CAD drawings available for download at www.pbclinear.com
For technical & application information call **1-888-777-1466**

The data and specifications in this publication have been carefully compiled and are believed to be accurate and correct. However, it is the responsibility of the user to determine and ensure the suitability of PBC Linear™ products for a specific application. PBC Linear™ only obligation will be to repair or replace without charge, any defective components if returned promptly. No liability is assumed beyond such replacement. Specifications are subject to change without notice. 6/27/08