

# Integral V

SNAP-IN SERIES

**NEW**

The Integral V™ system was developed to reduce costs, increase application flexibility and ease of installation. The rail consists of durable anodized aluminum framing and carbon steel angled raceways. Integral V components consist of various guide rails, snap-in clamps and carriages; each lending itself to high load capacity, rigidity and torque resistance. The **Snap-In Series** provides an extremely simple yet tough rail system.



PATENT PENDING



IVTAAJR  
#12 SNAP-IN

IVTAAKR  
#8 SNAP-IN

IVTAAJR  
#6 SNAP-IN

## FEWER COMPONENTS = LESS COST

- Rails snap into structural frame t-slots – easy assembly
- Available in three (3) sizes
- Lengths up to 4m
- End-joinable for longer runs
- **Applications:** automation, assembly, packaging, food processing, clean room and laboratory equipment



**DIMENSIONAL DATA**

IVTAAJR  
#6 T-SLOT

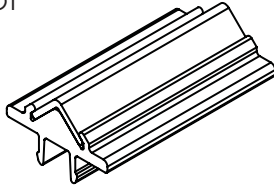

DETAIL A

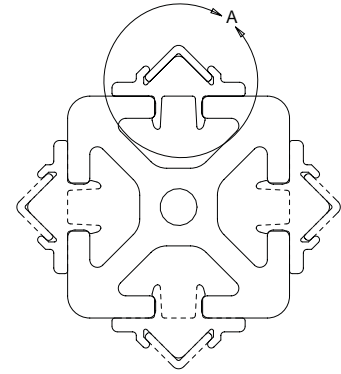
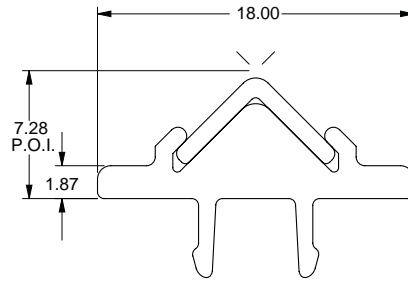

IVTAAKR  
#8 T-SLOT

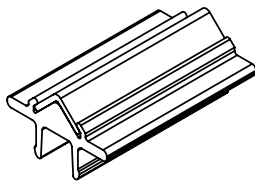

DETAIL B

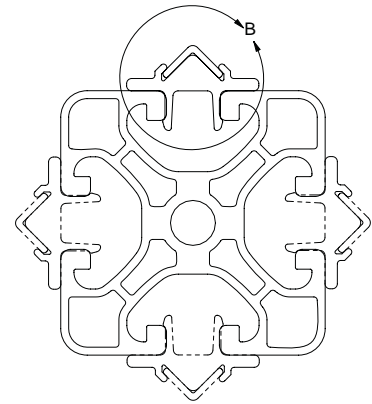
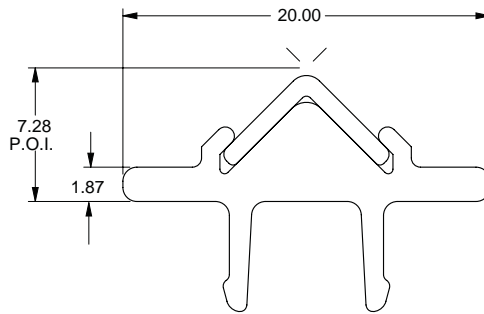

IVTAA LR  
#12 T-SLOT

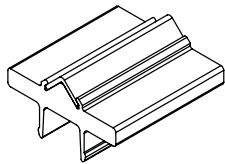

DETAIL C

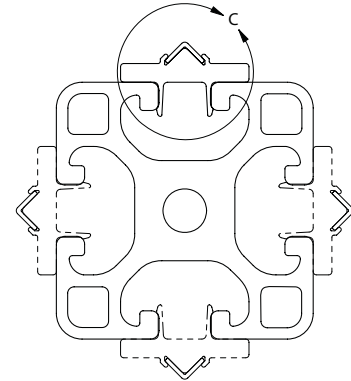
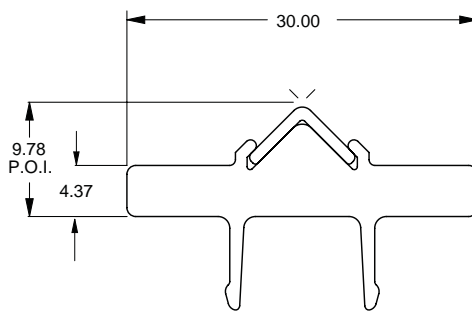

Part #	LOAD CAPACITY			
	Radial		Axial	
	Fz (N)	Fz (lbf)	Fy (N)	Fy (lbf)
IVTAAJR	600	135	300	67
IVTAAKR	750	169	375	84
IVTAA LR	800	180	400	90

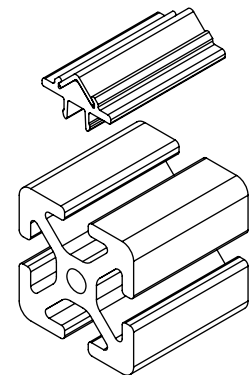
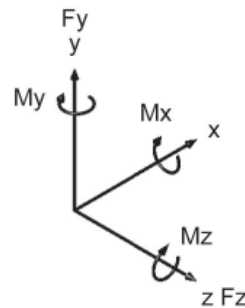

Load data show in table is based on 100 kilometer travel.

Product information and 2D/3D CAD drawings available for download at [www.pbclinear.com](http://www.pbclinear.com)  
For technical & application information call **1-888-777-1466**

The data and specifications in this publication have been carefully compiled and are believed to be accurate and correct. However, it is the responsibility of the user to determine and ensure the suitability of PBC Linear™ products for a specific application. PBC Linear™ only obligation will be to repair or replace without charge, any defective components if returned promptly. No liability is assumed beyond such replacement. Specifications are subject to change without notice.

